

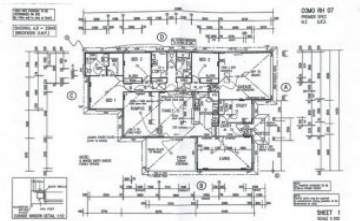

# CROWNE

REAL ESTATE



## 209/ Beeston Drive Fernvale QLD

This prime 2000 square metre corner block is set in the beautiful town of Fernvale with gorgeous views and surrounded by quality homes, just perfect for building your dream home. Fernvale is ideal for those looking for a country change without losing the convenience of shops, schools pubs and takeaways.

Situated a short distance from the Warrego Highway, a picturesque drive to Somerset Dam, or go for a bike ride on the rail trail.

Your dream can come true of building your own home so don't hesitate, come and have a look. Access to full town pressure water, power and NBN.

This rare block is only 4 minutes to the Fernvale Shopping Centre, 5 minutes to local Fernvale State School and 10

**Price** : Offers Over \$259,000  
**Land Size** : 2000 sqm  
**View** : <https://www.crownrealestate.com.au/7314728>



**Kay Sinclair**  
0417 607 287