

4 Martin Street Woodend QLD

3 1 2

Positioned in highly sought after Woodend, this incredibly well maintained home is being presented to the market for the first time. Boasting an elevated position and surrounded by many of Ipswich's finest homes, this property offers the opportunity to renovate a well-built home in a prestigious suburb.

Sitting on an elevated and flood free 715sqm block, this large family home is super solid!

Internally the square meterage is really quite large (see floor plan) and offers three impressive sized bedrooms, two equally impressive living areas, spacious kitchen and bathroom. This large home offers a fantastic opportunity to those looking to renovate to include an ensuited master bedroom.

Price : \$ 510,500
Land Size : 715 sqm
View : <https://www.crownrealestate.com.au/6992636>



Geoff Paulsen
0413 394 386



Ally Briscoe
0411 161 836

4 Martin Street, Woodend

4  1  2  734m² 

Internal Area: 120m²

External Area: 96m²

Total Area: 216m²

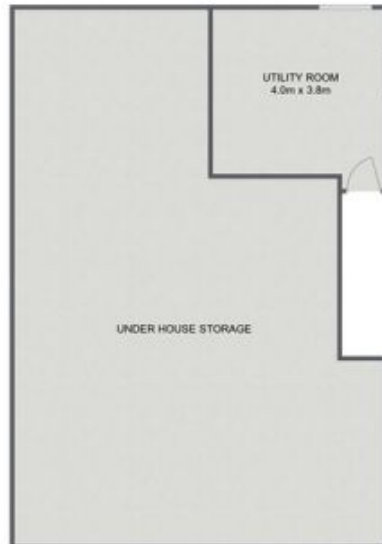

Whilst every attempt has been made to ensure the accuracy of the floor plan contained here, measurements of doors, windows, rooms and any other item are approximate and no responsibility is taken for any error, omission, or misstatement. This plan is for illustrative purposes only and should only be used as such by any prospective purchaser.