



**CROWNE**  
REAL ESTATE



### 29 Cabernet Crescent Pine Mountain QLD

4 2 4

This modern, well-appointed home is located on a 4000sqm parcel of land located in the highly sought after area of Pine Mountain, this home is move in ready and waiting for a new family to call it home. Don't miss this opportunity to purchase in this very popular location.

**Price** : \$ 875,000  
**Land Size** : 4000 sqm  
**View** : <https://www.crownrealestate.com.au/6903124>

Situated on a landscaped acre of land, this home offers 4 generous sized bedrooms all with built-ins, master with walk in robe and ensuite. The home has been refreshed throughout with new paint and carpet. The home offers formal and informal living areas as well as functional and accommodating central living space including modern kitchen with gas cooktop and stainless appliances. In total there is 3 to 4 living areas plus the teenage retreat. The home features plantation shutters throughout and is perfect for the Queensland climate with ceiling fans and fully air-conditioned. The garage can double as an additional



**Diann Platt**  
0407 673 756

CJ REPRESENTS  
ARY CONTROL JOINT.

FOR WINDOW DETAILS &  
EIGHTS, REFER TO SHEETS

BATH SET AT 500 ABOVE  
FL.

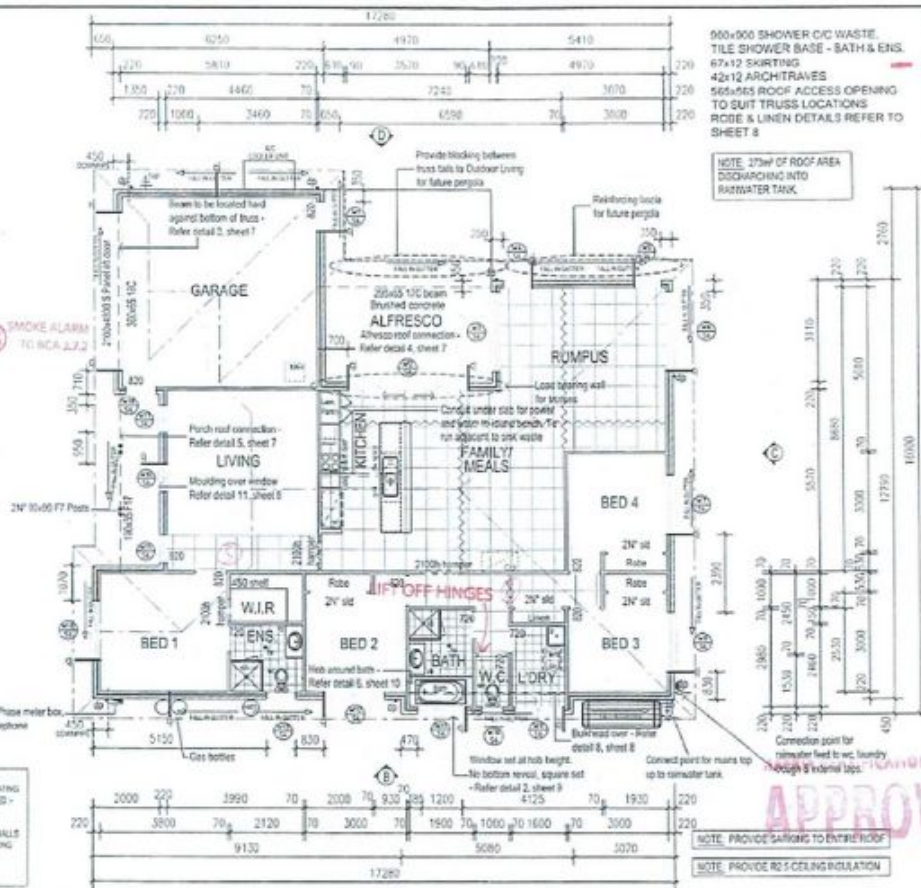

NO.	TYPE	DATE	SCALE

1948

NOTE: DO NOT SCALE THESE DRAWINGS

**FLOOR PLAN**

PROPOSED RESIDENCE  
FOR: MARIA COETZEE

AT: LOT 16 CABERNET CRES  
PINE MOUNTAIN

UBD REF.: 192 D18  
JOB N°-104134

**ORBIT HOMES**

ORBIT HOMES QUEENSLAND PTY. LTD.  
108 BRIDGEVIEW ROAD  
ACACIA RIDGE, 4110  
TEL: 3715 2095 FAX: 3715 2995  
www.orbithomes.com.au

**CONTRACT DRAWINGS**

ORBIT HOMES \_\_\_\_\_ DATE \_\_\_\_\_

CLIENT \_\_\_\_\_ DATE \_\_\_\_\_

CLIENT \_\_\_\_\_ DATE \_\_\_\_\_

REVISION	DATE	BY	SCALE
GROUP/FLOOR	1/16	4/16	1:100
DATE	14/05/07		
SHEET	No 3 OF 16		

DRAWN: BSE

DATE: 14.05.07

SHEET No 3 OF 16

WAVERLEY 25  
FEDERATION N3  
CLASSIC 07

NOTE: 5.5 STAR ENERGY EFFICIENCY RATING  
IN THE FOLLOWING MUST BE INSTALLED -

INSULATION BATT'S TO ALL CEILINGS  
DRIVE PILL UP TO ALL EXTERIOR WALLS  
IS A FRAME IS TO ALL EXTERIOR GLAZING  
HERE AFTER HANDOVER

WING ACHIEVED - 4.5 STARS

ORBIT HOMES QUEENSLAND Pty Ltd