



CROWNE

REAL ESTATE



51 Holdsworth Road North Ipswich QLD

3 1 1

This stunning three bedroom character home sits proudly on a fully fenced 809sqm corner block of land overlooking Ipswich City and to the mountains beyond. With all of the hard work completed this beautiful family home is ready for the new owners to move in and enjoy comfortable living.

Price : \$ 580,000
Land Size : 809 sqm
View : <https://www.crownrealestate.com.au/6806723>

Outstanding features of this home include:

- ? Traditional front verandah to welcome guests or to simply enjoy some relaxation
- ? All three sizeable bedrooms have fans; Two bedrooms also have air-conditioning and built in robes
- ? Spacious air-conditioned lounge room with decorative timber arch
- ? Entertainer's dining room which would house the largest of dining room tables
- ? Stunning new white kitchen complete with stone bench



Del Marschke
0401 485 304

51 Holdsworth Rd, North Ipswich

3  | 1  | 1  | 268m² 

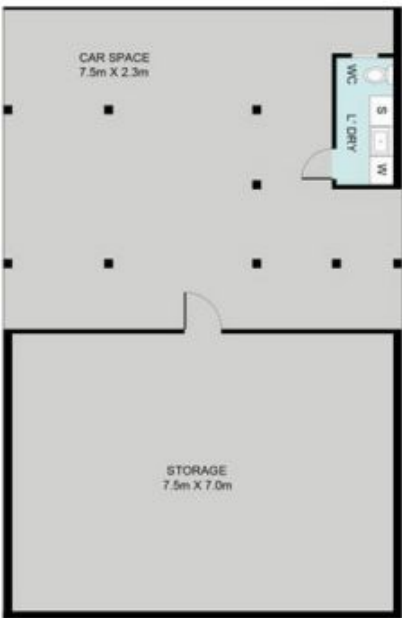

Whilst every attempt has been made to ensure the accuracy of the floor plan contained here, measurements of the doors, windows, rooms and any other items are approximate and no responsibility is taken for error, omission or mis-statement. This plan is for illustrative purposes only and should only be used as such by any prospective purchaser. The services systems and appliances shown have not been tested and no guarantee as to their operability or efficiency can be given.