



# CROWNE

REAL ESTATE



## 11 Whitehill Road Newtown QLD

3 1 1

Character Homes just give that nice and warm fuzzy feeling when you enter and this one certainly ticks that box. Located in the ever popular suburb of Newtown and surrounded by other period homes also within a short distance to Queens Park, the Nature Park and Japanese Gardens which is the ultimate spot to have the children play and explore. Central Primary School is a 3 minute drive and Girls Grammar is only a 3 minute walk away. The Ipswich CBD and Hospital are also within a very short distance.

Other key features of the home include;

- \* Polished timber floors flowing throughout the home and 9ft Ceilings giving plenty of air flow
- \* Neutral colours on the walls which are freshly painted
- \* The living and dining areas are defined with the dining area leading out to the back deck, a wood burner stove will

**View :** <https://www.crownerealestate.com.au/6751601>



**Cassandra Jeffs**  
**07 3288 8411**

▼ **Ground Floor**

TOTAL AREA: 121.04 m<sup>2</sup> • LIVING AREA: 121.04 m<sup>2</sup> • ROOMS: 5

**11 Whitehill Road, Newtown 4305**

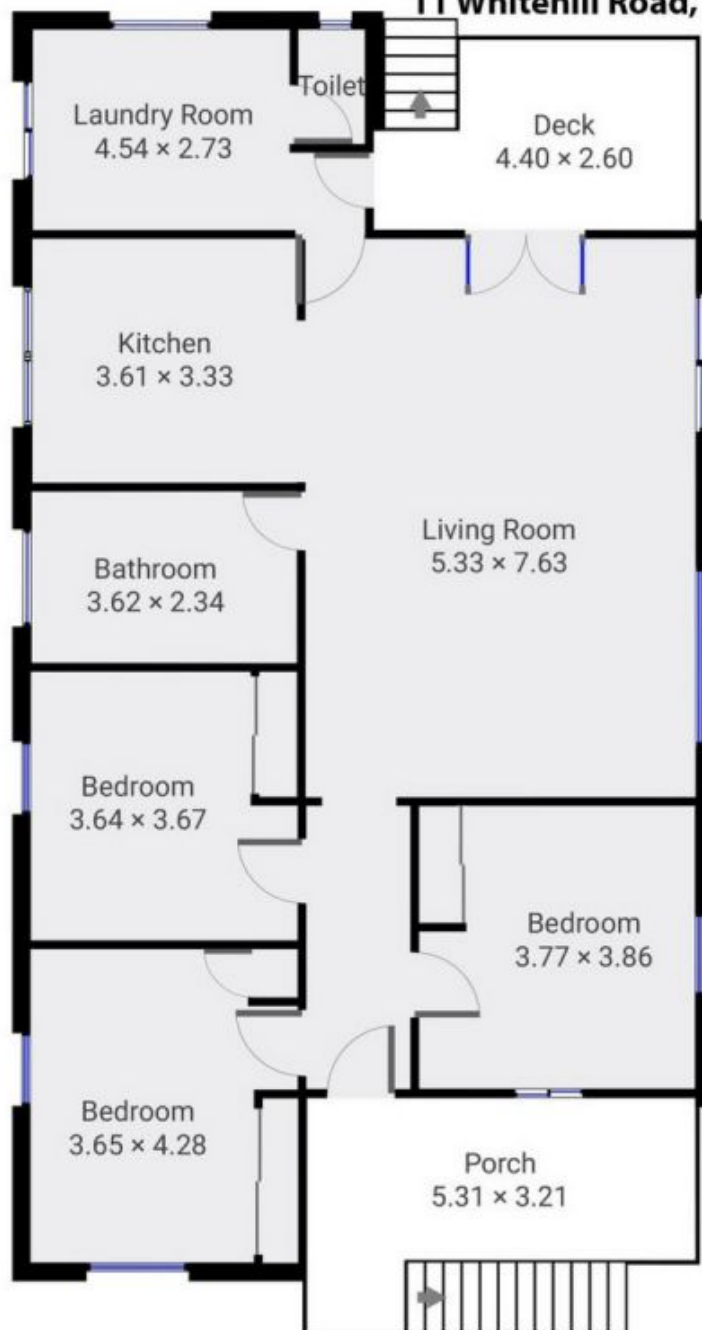

THIS FLOOR PLAN IS FOR ILLUSTRATIVE PURPOSES ONLY AS DIMENSIONS ARE APPROXIMATE.