



CROWNE
REAL ESTATE



30 Gledson Street North Booval QLD

4 2 5

A truly exceptional offering, this spectacular home set on a 1,012sqm allotment is ready to be renovated or enjoyed as is. Ideally positioned in one of Ipswich's most convenient suburbs, this fantastic property will impress with its beautiful traditional details and prime location.

Greeting you with a grand weatherboard exterior featuring exquisite latticework and a wrap-around verandah, the residence also showcases polished timber floors, lofty 12ft high ceilings, VJ walls, coloured glass windows and French doors.

Continuing from the home's welcoming entry, a spacious living area is punctuated by the combustion heater to help keep everyone cozy during the winter months and air conditioning for year-round comfort. Family meals can be enjoyed together in the huge 5.4 x 5.4m air-conditioned

Price : \$ 575,000
Building Size : 483 sqm
Land Size : 1012 sqm
View : <https://www.crownrealestate.com.au/6684185>



Corey Athanates
07 3288 8411

30 Gledson Street, NORTH BOOVAL



4 | 2 | 5 | 1012m²

Corey Athanates | 0413 992 959

Total approx floor area 483m² (not including carport)

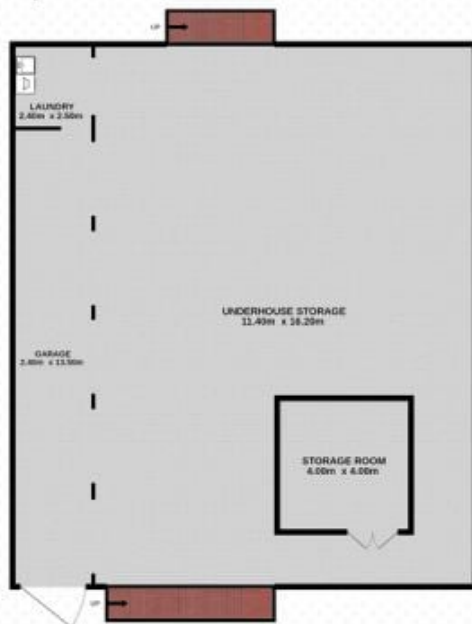

Whilst every attempt has been made to ensure the accuracy of the floor plan contained here, measurements of doors, windows, rooms and any other items are approximate and no responsibility is taken for error, omission or mis-statement. This plan is for illustrative purposes only and should only be used as such by any prospective purchaser. The services systems and appliances shown have not been tested and no guarantee as to their operability or efficiency can be given.