



# CROWNE

REAL ESTATE



## 21 ALICE Street Silkstone QLD

4 1 2

This unique family home is centrally located in a lovely quiet street in the family friendly suburb of Silkstone. Set in a desirable location on a huge 1095m<sup>2</sup> block, this 1920's built home sits behind gorgeous established trees and gardens and is a fine example of maximised use of graceful space whilst retaining the intrinsic original features including high ceilings, push out casement windows, stained glass and double French doors.

Fully fenced with a number of majestic leafy trees and fruit trees in the yard, offering your kids and pets a safe and secure area to play. There is a double carport on one side of the home and rear yard access on the other. Perfect if you want to park the caravan or boat or you could add a shed or pool.

The front porch is delightful and a perfect spot for an

**Price** : \$ 479,500  
**Land Size** : 1095 sqm  
**View** : <https://www.crownrealestate.com.au/6576734>



**Kirsty Dutney Jones**  
07 3288 8411



**Mike Jones**  
0400 515 422

## 21 Alice Street, SILKSTONE



4 | 1 | 2 | 1095m<sup>2</sup>

Total approx floor area 292m<sup>2</sup> (not including carport)

Kirsty Dutney-Jones | 0415 448 020

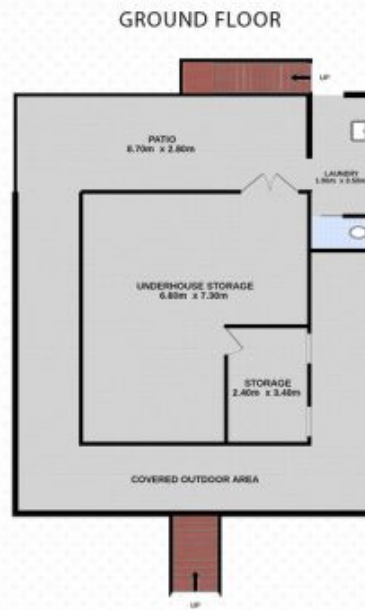

Whilst every attempt has been made to ensure the accuracy of the floor plan contained here, measurements of doors, windows, rooms and any other items are approximate and no responsibility is taken for error, omission or mis-statement. This plan is for illustrative purposes only and should only be used as such by any prospective purchaser. The services systems and appliances shown have not been tested and no guarantee as to their operability or efficiency can be given.