



CROWNE

REAL ESTATE



20 Quarry Street Ipswich QLD

3 1 2

This is an incredible opportunity to purchase this fantastic 111-year-old character home, that is waiting for you and your family or some very lucky tenants to live in one of Ipswich's most prestigious and sought-after streets.

Hideaway is a beautiful period home that is positioned amongst some of Ipswich's most exclusive and expensive homes yet it is conveniently located off the main road. Therefore, it is not prone to traffic noise but still boasts the same locale and proximity to Ipswich public and private schools, the University as well as the Ipswich CBD, shops, electric train and sporting/recreation facilities. It is such an ideal location for healthcare workers as it is only a short 5-minute walk to either the Ipswich General or St Andrew's Private hospitals.

This is a huge opportunity for not only first home buyers

Price : \$ 359,000
Land Size : 607 sqm
View : <https://www.crownrealestate.com.au/6531400>



Corey Athanates
07 3288 8411

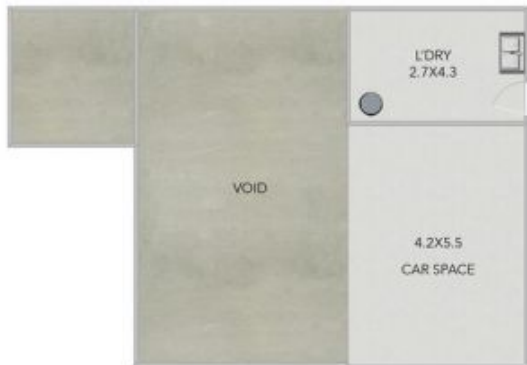

GROUND LEVEL



LEVEL 1

GUIDE ONLY NOT TO SCALE