



# CROWNE

REAL ESTATE



## 143 Geiger Road Allandale QLD

2 1

Here is your opportunity to lessen your Carbon Footprint, Live Green and Off the Grid or secure the Ultimate Weekend Getaway Home that is situated on a private and elevated Flood Free 6.17 Acre block.

Now just because this home is completely Off the Grid doesn't mean you need to give up all the comforts of modern day living. This fantastic home has been so well designed it offers a whole host of features that you probably wouldn't expect to see in an Off Grid home.

The home itself was built in 2001 by prominent local builder Phillip Cahill and a wide range of composite building materials have been used to construct this little gem. These include fibre-based cement sheeting, gyprock internal walls, hardwood timber trimming and decking, steel post stumping with adjustable tops, Colourbond steel roofing

**Price** : \$ 425,000  
**Building Size** : 234 sqm  
**Land Size** : 6.17 Acres  
**View** : <https://www.crownrealestate.com.au/6378938>



**Corey Athanates**  
**07 3288 8411**

# 143 Geiger Road, ALLANDALE



2 | 1 | 6.17 acres

Corey Athanates | 0413 992 959

Total approx floor area 234m<sup>2</sup> (not including shed)

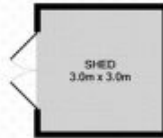

GROUND FLOOR

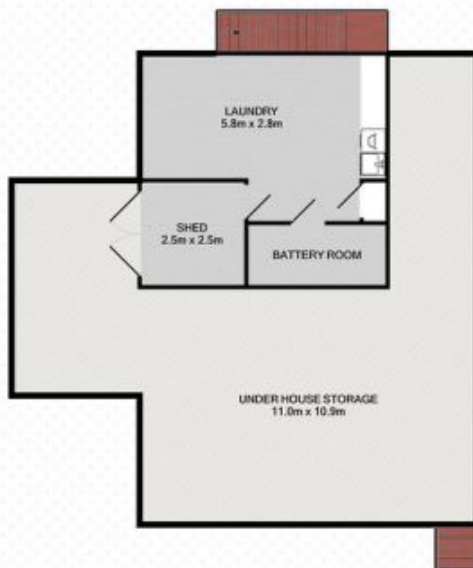

FIRST FLOOR



Whilst every attempt has been made to ensure the accuracy of the floor plan contained here, measurements of doors, windows, rooms and any other items are approximate and no responsibility is taken for error, omission or mis-statement. This plan is for illustrative purposes only and should only be used as such by any prospective purchaser. The services systems and appliances shown have not been tested and no guarantee as to their operability or efficiency can be given.