



# CROWNE

REAL ESTATE



## 22 Challinor Street SADLIERS CROSSING QLD

3 1 4

This amazing piece of Ipswich History is presented to the market for sale.

One of the first dozen homes ever built in Ipswich.

This unique property is a must see and will need to be viewed to experience all its charm.

"Yarrum Lodge? or also known as "Bailey's Lodge? was known as the "Cobb and Co? stop off. This is a true piece of Ipswich history from the brick chimney to the six panes cedar window. This quirky home will captivate you as a feeling of nostalgia fills you in every room.

The home has undergone a massive renovation over the years, with new plumbing, flooring, walls, re-wiring and meter board, kitchen, bathroom, ceiling and much more.

**Price** : \$ 360,000  
**Land Size** : 536 sqm  
**View** : <https://www.crownerealestate.com.au/6314043>



**Kirsty Dutney Jones**  
07 3288 8411



**Mike Jones**  
0400 515 422



# 22 Challinor Street Sadliers Crossing

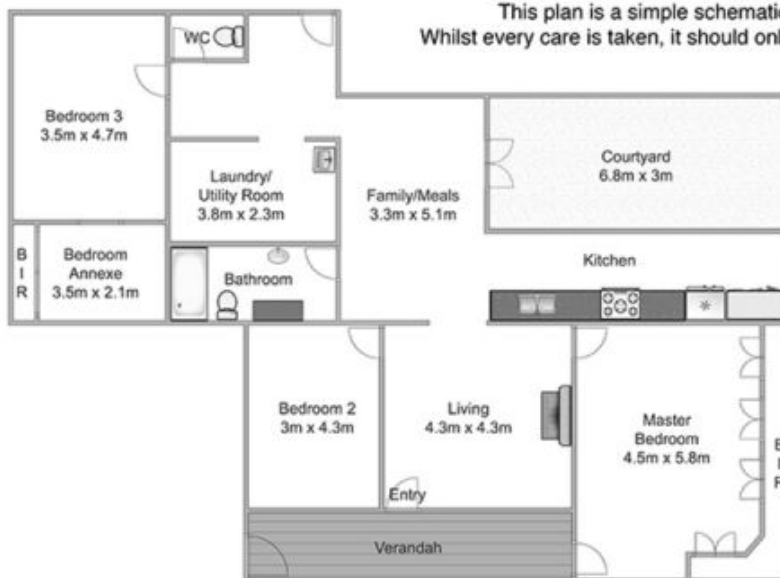

This plan is a simple schematic representation of the property.  
Whilst every care is taken, it should only be considered as an artist impression.