

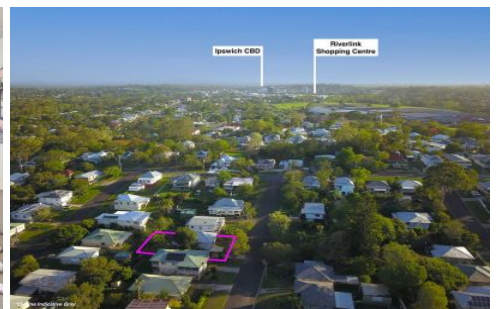

**CROWNE**  
REAL ESTATE



### 3A Fitzgerald Street North Ipswich QLD

3 1 2

Located on a quiet little backstreet of North Ipswich sits this fantastic renovated post war home that is situated on a level and flood free block. All the hard work has been done, so all you need to do is move in and enjoy.

From the minute you arrive at the property you can't help but be impressed with how quiet the street is, which is very rare for such a prime positioned location to absolutely everything. This amazing home was built in 1960 and as you are walking towards the house you can see that it has been well cared for over its 60 years of existence.

Entering the home via the front stairs which have a decked landing, you are absolutely blown away by the modern renovations that work in conjunction with the character and charm of a bygone era. From the fresh look timber laminate floors, grey walls with white trimming, to the

**Price** : \$ 370,000  
**Building Size** : 253 sqm  
**Land Size** : 475 sqm  
**View** : <https://www.crownrealestate.com.au/6140531>



**Corey Athanates**  
07 3288 8411

# 3A Fitzgerald Street, NORTH IPSWICH



3 | 1 | 2 | 475m<sup>2</sup>

Corey Athanates | 0413 992 959

Total approx floor area 253m<sup>2</sup> (including covered external areas)

GROUND FLOOR

FIRST FLOOR

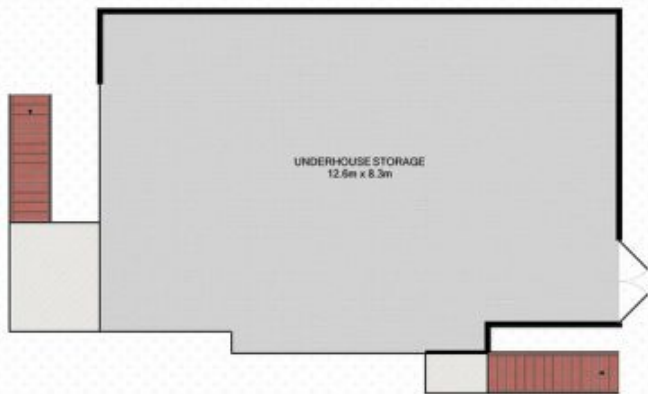

Whilst every attempt has been made to ensure the accuracy of the floor plan contained here, measurements of doors, windows, rooms and any other items are approximate and no responsibility is taken for error, omission or mis-statement. This plan is for illustrative purposes only and should only be used as such by any prospective purchaser. The services, systems and appliances shown have not been tested and no guarantee as to their operability or efficiency can be given.

