



# CROWNE

REAL ESTATE



## 19 Watsonia Drive Leichhardt QLD

3 2 1

This generously sized family home has so much to offer. Situated on 809m<sup>2</sup> in a quiet street close to schools, local shops and transport and only minutes to everything West Ipswich and Ipswich CBD has to offer, this one will not last long. The street itself is largely owner occupied and properties here are long held. This home is everything a family could want upstairs for comfortable living including ducted air con and a fireplace, plus it has the added advantage of being fully enclosed underneath and although it's a fraction off legal height, the space is still there to be utilised as you wish.

### Features Include

#### Upstairs:

3 bedrooms with built ins

Timber floors

Ceiling fans throughout

**Price** : \$ 275,000  
**Land Size** : 809 sqm  
**View** : <https://www.crownrealestate.com.au/5285280>



**Jenni Hood**  
0400 930 470

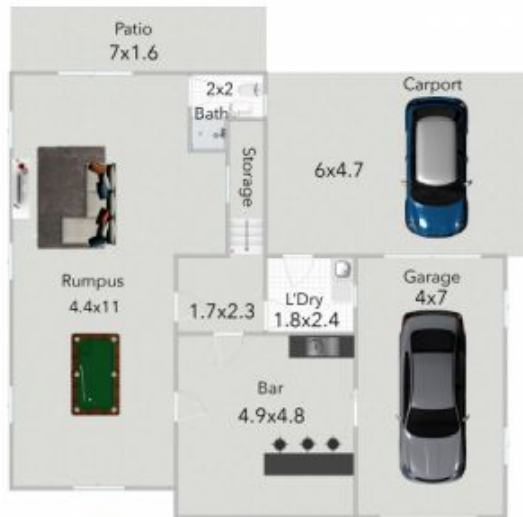

Ground Level

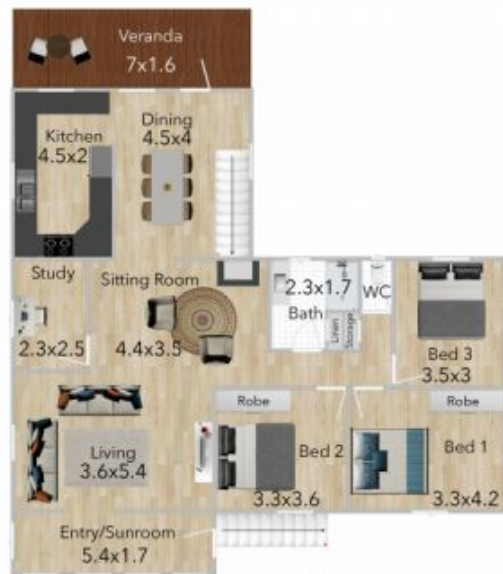

Level 1