



CROWNE

REAL ESTATE



18 Beames Drive Laidley South QLD

4 1 4

Situated on 14 Acres (56,656m²) is this fantastic family home with picturesque views of the countryside, less than 5 minutes from the rapidly growing Laidley Township.

This amazing home boasts open plan living with an absolutely huge tiled living and dining area which has ceiling fan and a large air conditioner, complete with brand new kitchen and fire place installed just before winter this year!

All four (4) bedrooms are generously sized and have built-ins and three of which including the master have ceiling fans and a/c.

The main bathroom has it's own linen cupboard for easy access to a soft dry towel and a separate toilet. The newly renovated laundry is stunning and sure to please also.

Price : \$ 470,000
Land Size : 14.3 Acres
View : <https://www.crownrealestate.com.au/5008774>



Corey Athanates
07 3288 8411

18 Beames Drive, LAIDLEY SOUTH

4  | 1  | 4  | 14.4 acres 

Total approx floor area 268m² (including covered external areas)



CROWN
REAL ESTATE

Corey Athanates | 0413 992 959

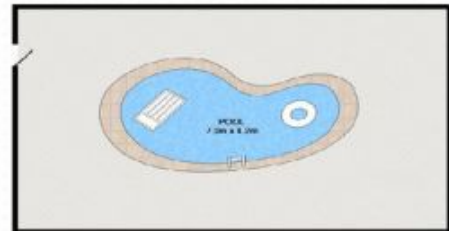

Whilst every attempt has been made to ensure the accuracy of the floor plan contained here, measurements of doors, windows, rooms and any other items are approximate and no responsibility is taken for error, omission or mis-statement. This plan is for illustrative purposes only and should only be used as such by any prospective purchaser. The services systems and appliances shown have not been tested and no guarantee as to their operability or efficiency can be given.