

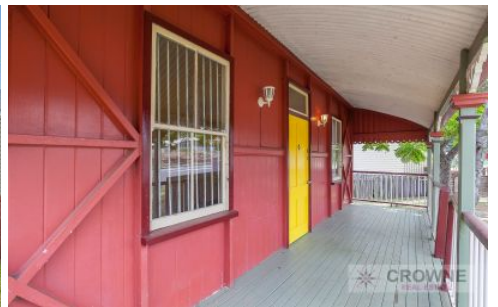

CROWNE

REAL ESTATE



25 Delacy Street NORTH IPSWICH QLD

3 1 1

This place is so welcoming. It has all of the charm of a miner's cottage with a block that hasn't been cut up which is getting harder and harder to find. It's a great way to get into the market and have the ability to add huge value for minimal outlay. It has -

3 bedrooms
Good sized lounge room
Verandah across the front
Timber floors
Kitchen out the back with a view
And so much more.

There is a bit of updating and renovating to be done on this place but there's nothing that needs to be done before you move in.

Price : \$ 225,000
Land Size : 1012 sqm
View : <https://www.crownerealestate.com.au/4581002>



Jenni Hood
0400 930 470

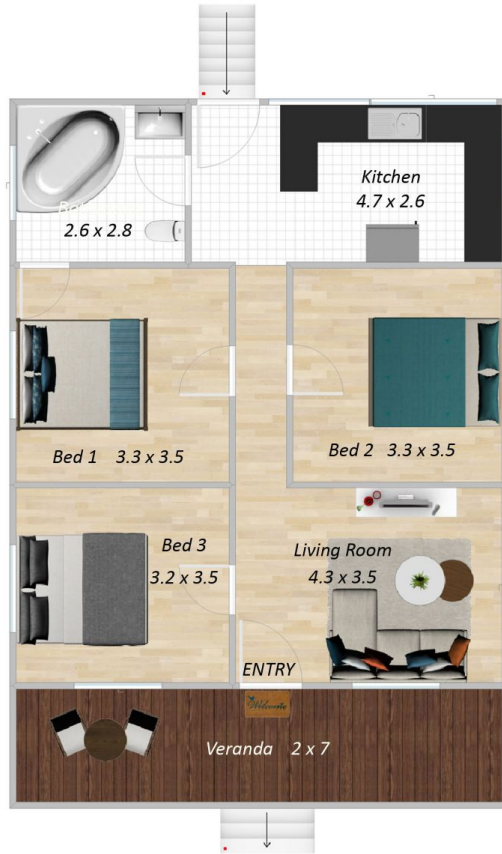

25 Delacy Street, North Ipswich.
GUIDE ONLY NOT TO SCALE.